

INDOOR EXHIBITS

HPBExpo 2011
 Exposition: MARCH 3-5
 SALT PALACE C.C.
 Halls A-C; 1-5
 SALT LAKE CITY, UT

as of 08/17/2010



EXIT TO OUTDOOR
 BURN AREA SHUTTLE
 PICK-UP

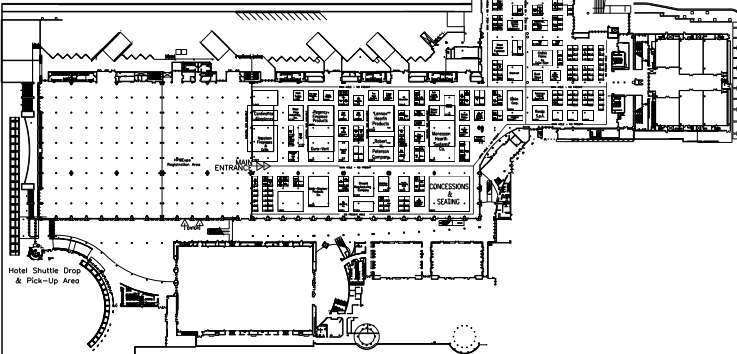
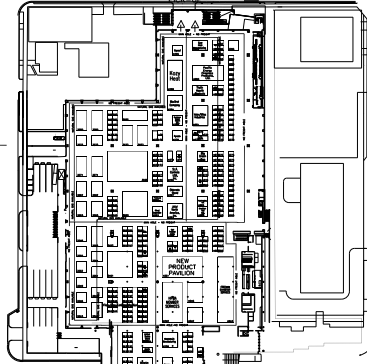

OUTDOOR EXHIBITS

